



6.3 Software update via "+3 SD Card Black Box"

6.3.1 Preparation for programming

Can only be inserted into +3 models

6.3.1.1 Correct SD card

The SD cards which have passed our tests (see illustration 512MB) are the 128MB and 512MB ones from **SanDisk**.

Not all SD card manufacturers are suitable for the Black Box. Some manufacturers do not support the operating mode necessary for the Black Box.



6.3.1.2 Formatting the SD card to **FAT** file system

Caution:

Formatting deletes all data on the SD card!

Info:

Formatting to the **FAT** file system must only be performed once. Future update files can be copied directly onto the SD card.
SD cards supplied by CONVOTHERM are already formatted to FAT format.

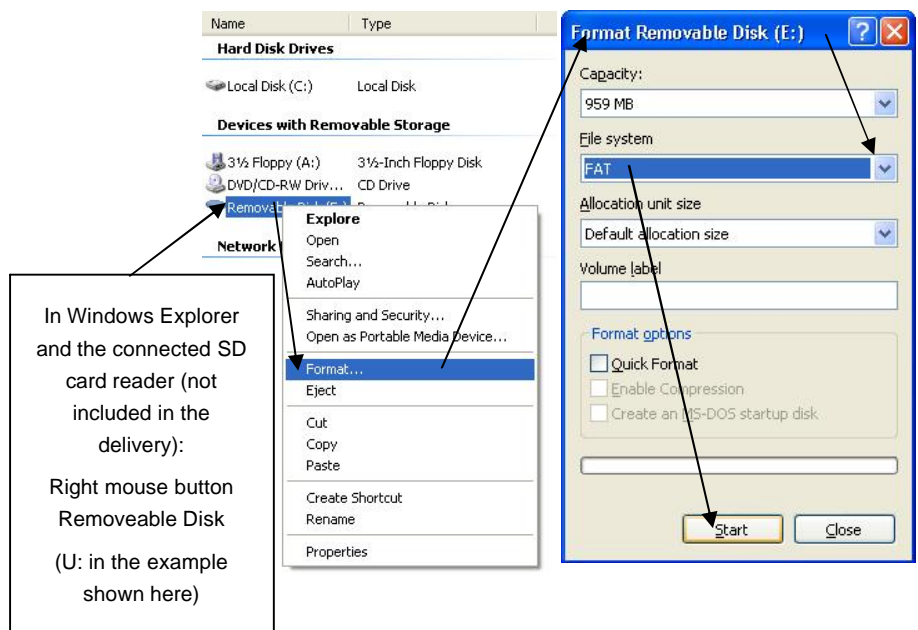

6.3.1.3 Coping the 5 BIN files to the SD card

All **five** BIN files (see example in the illustration on the right), which you receive via CD, e-mail, SD card or ... from the Customer Service department, must always be copied together onto the SD card (onto the SD card formatted to FAT file system format).

These files must not be mixed with older ones and must not be renamed.

Name	Size	Typ
BM.bin	127 KB	BIN-D
Flashm.bin	139 KB	BIN-D
Flashs.bin	140 KB	BIN-D
sdmnc.bin	32 KB	BIN-D
SM.bin	121 KB	BIN-D



6.3.2 Sequence of the update procedure

The entire software update procedure may last 3-6 minutes, depending on the scope of the update.

- a) If necessary, store your own recipes in the IDM.
- b) Store IDM information in cache memory (only necessary in software version 4.03 or older):
 - 1) Switch Convotherm on using the On / Off button.
 - 2) If necessary, answer the question after the DE flushing with "no".
 - 3) Switch to the Service level (3-button manoeuvre).
 - 4) Via the Service programme c12 or c13, select the "Dummy Version" (c12 on 300, c13 on 999)
 - 5) Switch to c14 and exit the Service level.
 - 6) Press the On / Off button for 5 seconds to restart the electronics.
 - 7) Switch Convotherm on using the On / Off button.
 - 8) If necessary, answer the question after the DE flushing with "no".
 - 9) Switch to the Service level.
 - 10) Via the Service programme c12 or c13, select the "Dummy Version" (c12 on 300, c13 on 999).
 - 11) Switch to c14 and exit the Service level.
 - 12) Press the On / Off button for 5 seconds to restart the electronics.
- c) Disconnect appliance from the mains.
- d) Remove Operating Mode (BM) panel (pull forwards and place on the top of the appliance), but do not disconnect the cable from the BM. The BM panel must have a direct conducting metal contact with the Convotherm during the programming procedure.
- e) Remove X12 connection plug from the Control Module (SM).
- f) Plug SD card in SD card box, taking care to position the SD card correctly.
- g) Connect the SD card box with the Control Module (slot X18 at the top of the SM), if necessary, remove an existing Communications Module (KM) or cable.
- h) Fasten black earth cable from the black box to the Convotherm housing, using a crocodile clip.
- i) Reconnect appliance to the mains.
- j) Programming starts automatically and can last 3 to 6 minutes. If programming and initialisation are successful, the time and date are displayed on the BM and the green LED is lit permanently on the SD card box.
Should after about 7 minutes the date not be displayed and the red LED is flashing as well as the green one being permanently lit, without removing the SC card, disconnect the appliance from the mains and reconnect it; wait until the date is in the display and the green LED on the SD card box is permanently lit.
- k) Disconnect appliance from the mains.
- l) Disconnect SD card box from the Convotherm and, if necessary, reconnect the previously disconnected KM or cable to SM X18.
- m) Reconnect X12 to the SM.
- n) Check that the other plugs are firmly inserted (SM and, if necessary, also the gas module GM)
- o) Re-insert the BM panel.
- p) Reconnect appliance to the mains.
- q) Switch appliance on.
- r) If necessary, reset desired language.
- s) If necessary, reload the recipes stored under point a) from the IDM.